

LED Omega Batten



INDOOR SERIES



PRODUCT OVERVIEW

The AL TSA Omega Batten is a premier linear, linkable light solution for any personal or workspace.

With its high-tech optical design and full aluminium housing, the AL TSA Omega Batten does not only provide a functional lighting solution but is also aesthetically appealing.

The AL TSA Omega Batten can be linked in an array of up to 42 meters long, it also comes with optional motion sensors that provide bi-level dimming and control, energy and maintenance costs can be dramatically reduced.

The lens is constructed from PMMA material and can be supplied in various beam angles to suit any lighting application.

Quality comes standard...



Hours
LIFESPAN



IP65
INDOOR



Low
MAINTENANCE



Year
WARRANTY



Product
CERTIFICATION

APPLICATIONS

Warehouses

Factories

Parking Areas

Offices

Supermarkets

Workshops

FEATURES

Linear design

High Luminous Efficiency

Excellent heat dissipation

Temperature: -20°C ~ +50°C

PIR Sensor optional

CONSTRUCTION

Aluminium Housing

PC Lens

Silver/White Finish

IP65 Ingress Protection

IK08 Impact Resistance

LED Omega Batten

TECHNICAL DATA

MODEL No.:	VOLTAGE (V)	POWER (W)	LUMEN (lm/W)	BEAM ANGLE	CRI	SIZE (MM)	CCT (K)
MB/Y/LINEAR/20W	100-265	20	100/130	120°	>80	600x72x54	2200-6000
MB/Y/LINEAR/40W	100-265	40	100/130	120°	>80	1200x72x54	2200-6000
MB/Y/LINEAR/60W	100-265	60	100/130	120°	>80	1500x72x54	2200-6000

Lumen Output: 110lm/W (110) / 130lm/W (130)

Glare Rate: UGR 22

MECHANICAL DATA

Lamp Description:	Hongli 2835		
Operating Temperature:	-20°C ~ 50°C		
Housing Material:	Aluminium		
Lens Material:	PC With IK08 Impact Resistance		
Glare Index:	UGR22		
Housing Finish:	Silver/White		
IP Rating	IP65		
Mounting Configuration:	Surface		
Sizes:	600x72x54	1200x72x54	1500x72x54
Wattage:	20W	40W	60W
Flicker Specification:	SVM<0.4		

ELECTRICAL DATA

Driver:	Zhengyuan	EMC Applicable
Electrical Class:	Class 1	Triac Dimmable
Nominal Voltage Range:	184 - 265 VAC	Dali Control
Power Factor:	>0.95	1-10V Control
THD:	12%	Motion Sensore
Surge Protection:	Standard 1000V- Optional 2750V	Battery Backup 20% 30-90 Minutes
Photocell:	External	

LED Omega Batten

TECHNICAL DATA | Sensor

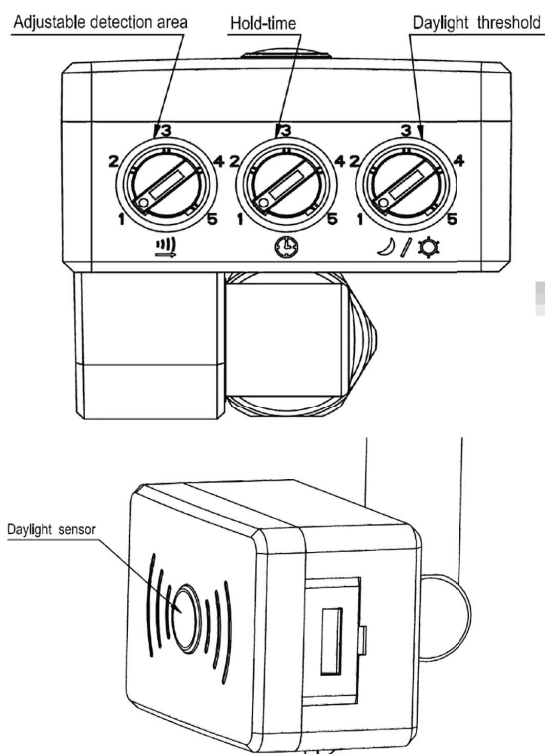

Operating Voltage	220-240VAC, 50Hz
Rated Load	400W (Inductive), 800W (Resistive)
HF System	5.8GHz +/- 75MHz, ISM waveband
Transmitting Power	<0.5mW
Power Consumption	<0.5W (Standby)
Detection Area	43 (@ 3m Mounting Height) 10m (@ 1.5m Wall mounting height)
Detection Sensitivity	10%, 25%, 50%, 75%, 1000%
Hold Time	5s, 30s, 90s, 3min, 30min
Daylight Sensor	2lux, 10lux, 25lux, 50lux, Disabled
Mounting Height	6m Max
Motion Detection	0.5-3m/s
Detection Angle	150° (Wall installation) 360° (Ceiling Installation)
Operating Temperature	-25°C ~ 60°C

DIMENSIONAL DATA | Sensor

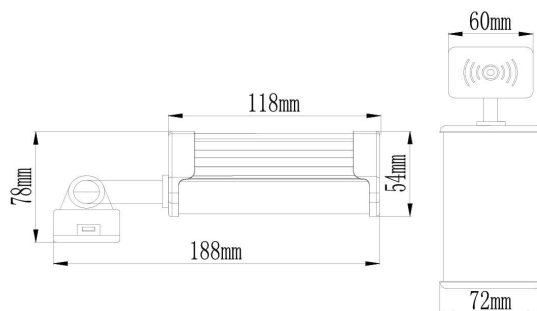

MODEL No.:	INPUT Voltage	Max. Units Per Sensor
LIN/OMB/20/*/**/***	240VAC, 20W	10
LIN/OMB/40/*/**/***	240VAC, 40W	5
LIN/OMB/60/*/**/***	240VAC, 60W	4

LED Omega Batten

INSTALLATION OPTIONS

Suspended

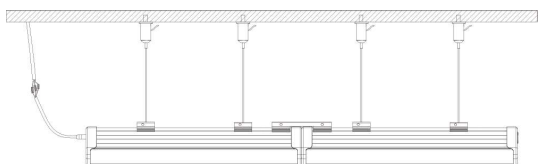

Surface

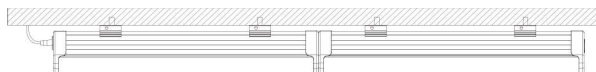

DIMENSIONAL DATA

